

EV RANGE MULTI-SPEED GLANDLESS CIRCULATORS

for heating/chilled and
H.W.S. applications

SMEDEGAARD INTRODUCES THE CIRCULATOR WITH ONLY 3 ASSEMBLIES

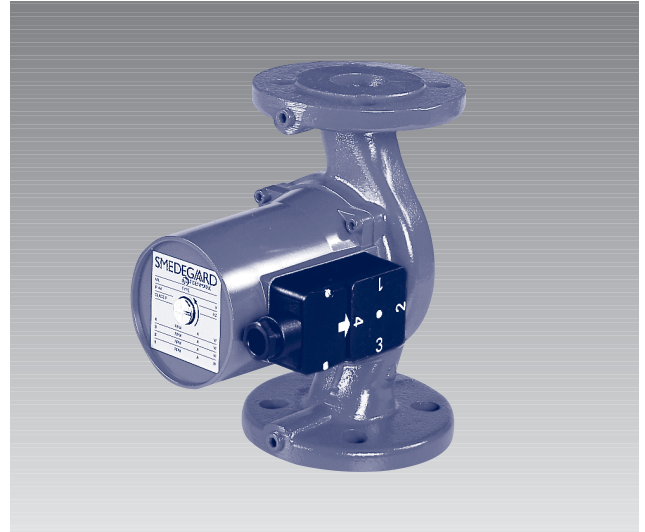

- Unique 1 -2-3 modular pump construction
- One piece stainless steel can.
- Built-in noise suppression for ultra quiet operation.
- Hardened stainless steel shaft with carbon bearings.
- Clearly visible multi-speed electrical regulator.
- Advanced lubrication system to prolong bearing life.
- Pump casing: PN 10, standard port to port dimensions
Flanges: DN 40, 50 ,65, PN 6/10 double drilled (DIN 2533).
DN 80, PN 16 (DIN 2533).
- Available with iron and brass unions 3/4", 1", 1 1/4" and threaded or welded counter flanges 40, 50, 65 and 80mm.
- Same pump suitable for heating and chilled water systems (max glycol solution 50%).
- Temperature range -15° C to +120° C, except EV 2/3-40/65/70-2, 110° C max.
and larger single phase pumps EV 4-95-2 and above, 100 ° C max.
Maximum working pressure 10 bar.
- Eurovoltage 1~230V and 3~400V, +6 %, -10%, 50Hz. IP 44, Class F.
- Model C: Dark blue heating/chilled pump
Model CD: Single-case twin pump
Model Z: Yellow bronze H.W.S. pump.
Model VZ: Yellow bronze H.W.S. pump with anti-lime system.
Model V: Yellow iron H.W.S. pump with anti-lime system.
- Smedegaard offers an extensive range of pumps and controls for the H & V industry,
including IsoBar electronic circulators.

EV RANGE MULTI-SPEED GLANDLESS CIRCULATORS

for heating/chilled and H.W.S. applications

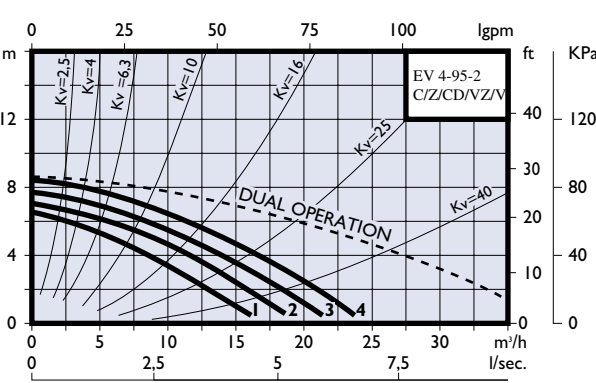
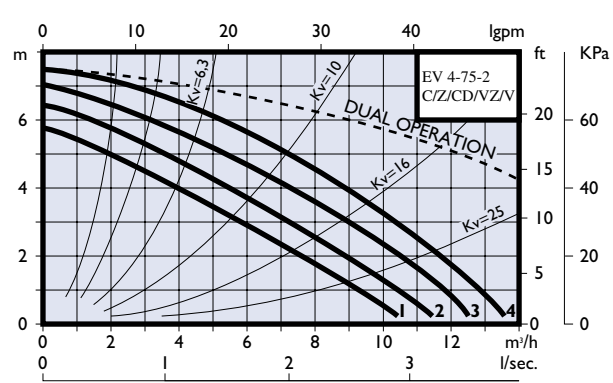
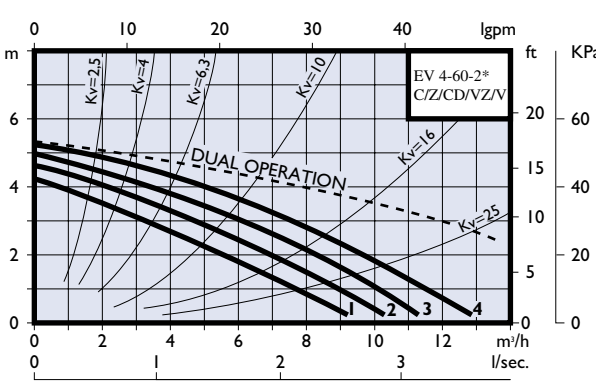
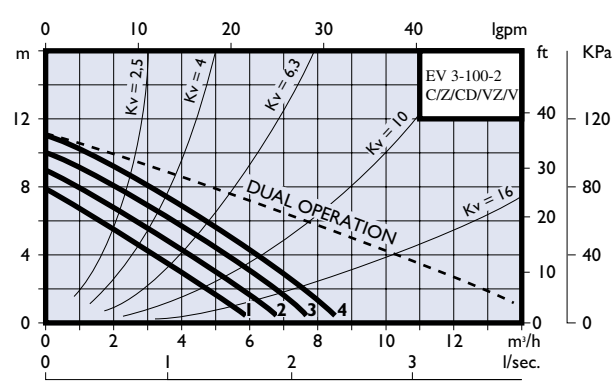
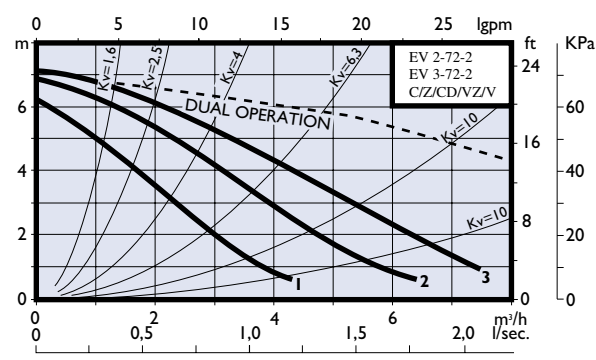
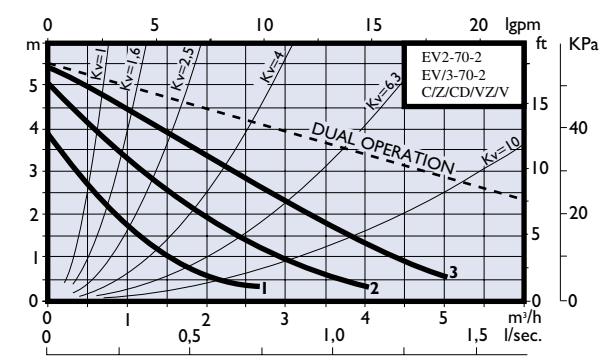
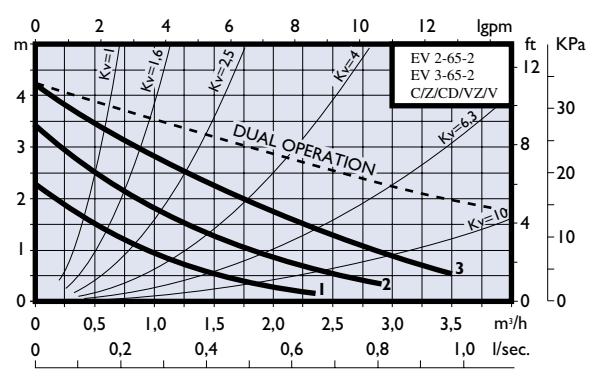
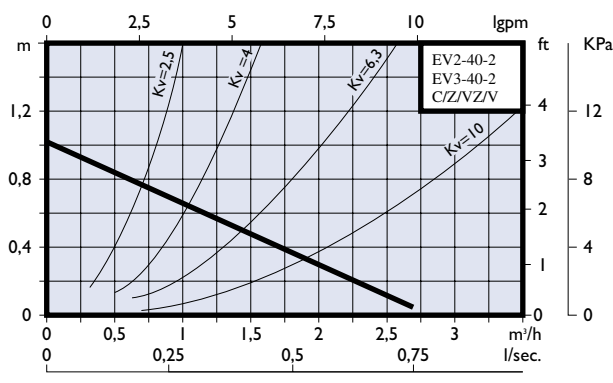

C= Dark blue heating/chilled. CD= Single case twin pump. Z= Yellow bronze H.W.S. pump. VZ= Yellow bronze H.W.S. V= Yellow iron H.W.S pump.
 * EV2/3-72-2, 3 x 400V = 4 speed, EV 4-60-2, 1 x 230V = 3 speed

EV RANGE MULTI-SPEED GLANDLESS CIRCULATORS for heating/chilled and H.W.S. applications

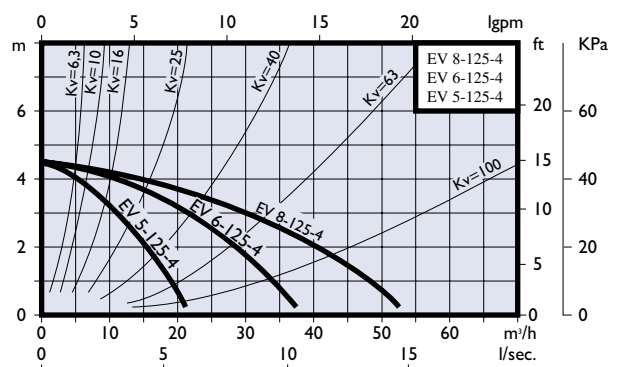
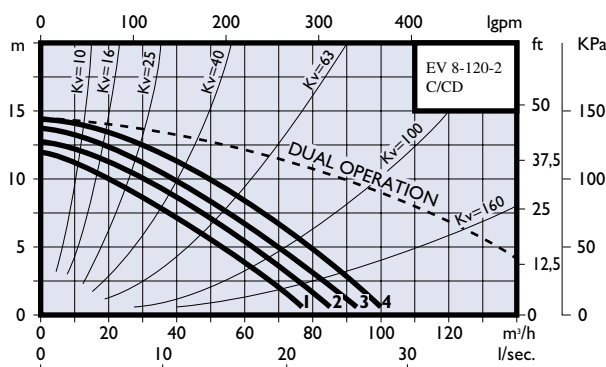
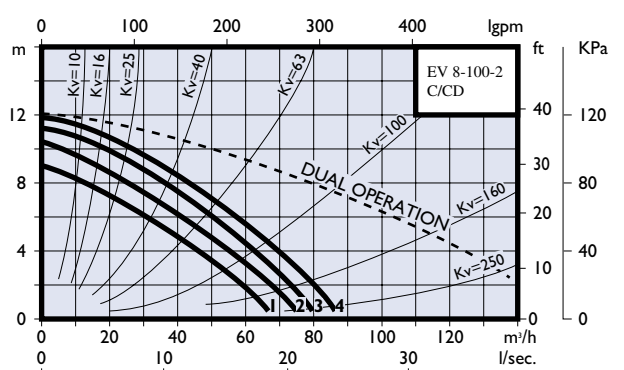
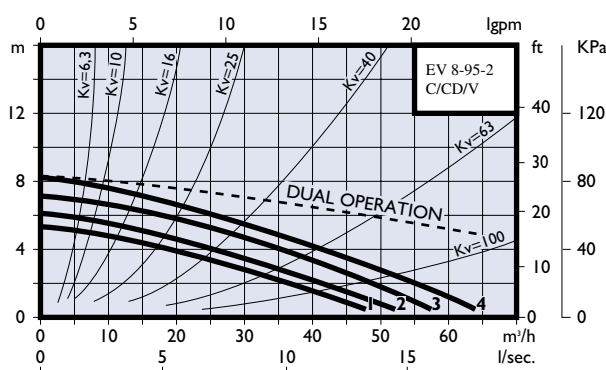
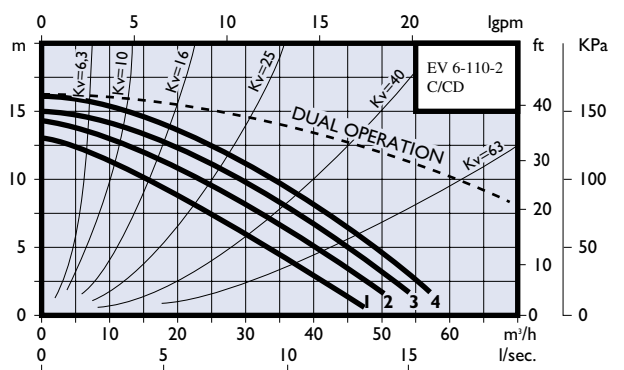
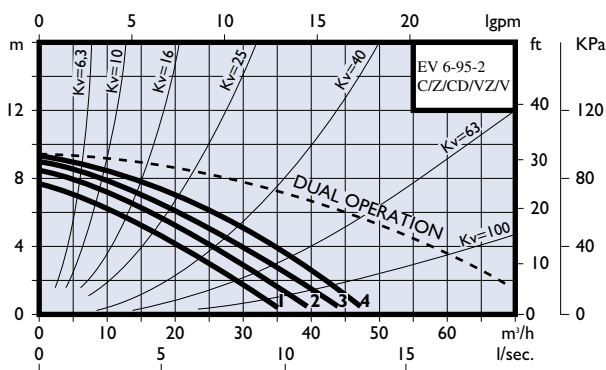
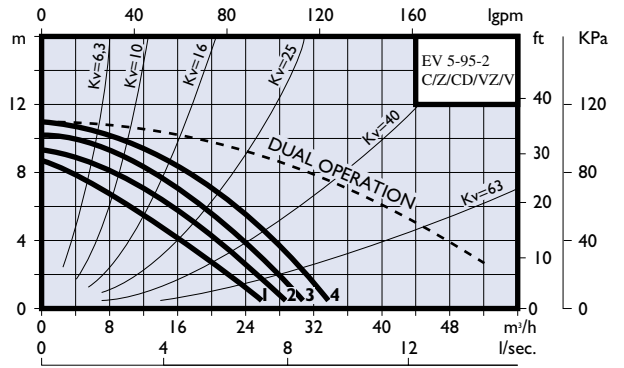
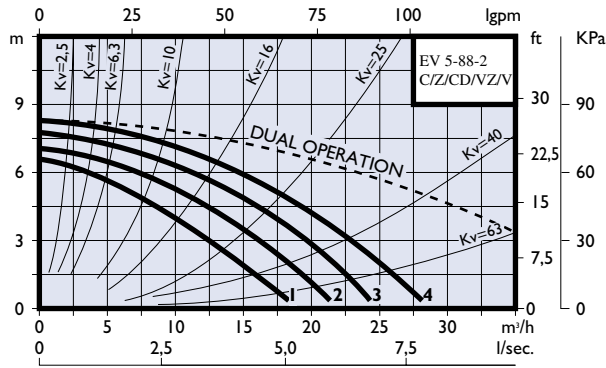

Hydraulic performance acc. to PrEN 9906 Grade 2 and PrEN 1151.

Complete range of 1400 rpm pumps available.

EV RANGE MULTI-SPEED GLANDLESS CIRCULATORS

for heating/chilled and H.W.S. applications

Dimensions:

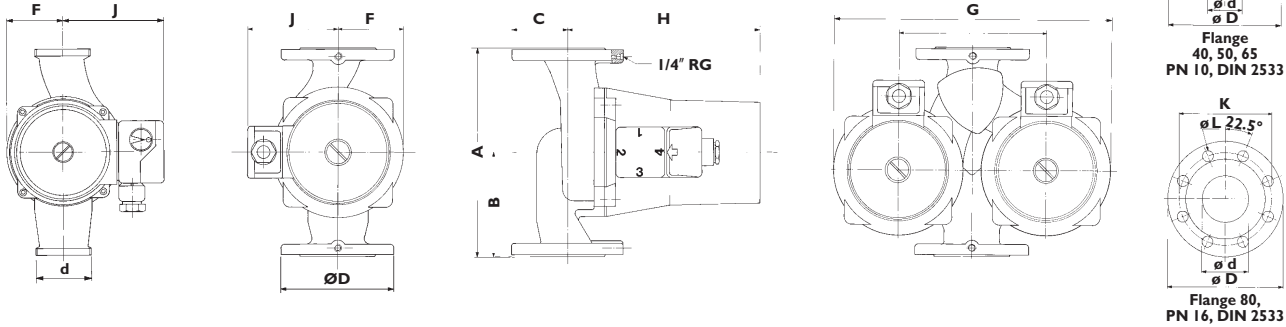

TYPE	Blue		Yellow		A	B	C	D	d	F	G	H	J	PN 6		PN 10		Weight (kg)	
	C	CD	Z	VZ										K	L	K	L	Single	Twin
EV2/3-40-2	•	•	•	•	130/180	90	40	-	3/4"-1"-11/4"	50	-	110	85	-	-	-	-	2,6	-
EV2/3-65-2	•	•	•	•	130/180	90	40	-	3/4"-1"-11/4"	50	245	110	85	-	-	-	-	3,2	6,8
EV2/3-70-2	•	•	•	•	130/180	90	40	-	3/4"-1"-11/4"	50	245	110	85	-	-	-	-	3,2	6,8
EV2/3-72-2	•	•	•	•	180	90	40	-	1"-11/4"	50	245	145	85	-	-	-	-	4,5	8,5
EV 3-100-2	•	•	•	•	180	90	40	-	11/4"	65	305	180	95	-	-	-	-	6,5	13,5
EV 4-60-2	•	•	•	•	250*	125	75	150	40	75	350	160	90	100	14	110	19	10	18,2
EV 4-75-2	•	•	•	•	250	125	75	150	40	75	350	165	95	100	14	110	19	11,3	19
EV 4-95-2	•	•	•	•	250	125	75	150	40	75	350	200	105	100	14	110	19	14,2	25
EV 5-88-2	•	•	•	•	280	140	83	165	50	85	390	200	105	110	14	125	19	17,5	29,5
EV 5-95-2	•	•	•	•	280	140	83	165	50	95	390	230	125	110	14	125	19	28,6	52
EV 6-95-2	•	•	•	•	340	170	93	185	65	105	455	235	125	130	14	145	19	35	60,5
EV 6-110-2	•	•	•	•	340	170	93	185	65	105	455	285	125	130	14	145	19	41,5	72
EV 8-95-2	•	•	•	•	360	185	100	200	80	105	505	240	125	-	-	160	19	42	72,5
EV 8-100-2	•	•	•	•	360	185	100	200	80	105	510	290	125	-	-	160	19	49,5	85,5
EV 8-120-2	•	•	•	•	360	185	100	200	80	105	510	290	125	-	-	160	19	50	86,5
EV 5-125-4	•	•	•	•	280	140	83	165	50	85	390	200	105	110	14	125	19	17,5	33
EV 6-125-4	•	•	•	•	340*	170	93	185	65	105	455	235	125	130	14	145	19	34,5	58,5
EV 8-125-4	•	•	•	•	360	185	100	200	80	105	510	240	130	-	-	160	19	42	72,5

* Also available with 220mm (EV4-67-2C) and 300mm (EV6-135-4C).
 When both PN 6 and PN 10 are shown, the pump is supplied with flanges double drilled to facilitate interchangeability when used for replacement. Note: 80mm pump casing can be supplied drilled PN6 to special order.
 C= Dark blue heating/chilled. CD= Single case twin pump. Z= Yellow bronze H.W.S. pump. VZ= Yellow bronze H.W.S.pumps. V= Yellow iron H.W.S pump. V and VZ including TUT anti - lime system. Max 65°C recommended for H.W.S. pumps.

TYPE	Blue		Yellow		Absorbed power	F.L.C. Amps Speed 1			F.L.C. Amps Speed 2			F.L.C. Amps Speed 3			F.L.C. Amps Speed 4		
	C	CD	Z	VZ		Min.-max.	1x230	3x230	3x400	1x230	3x230	3x400	1x230	3x230	3x400	1x230	3x230
EV2/3-40-2*	•	•	•	•	55	-	-	-	-	-	-	0,28	-	-	-	-	-
EV2/3-65-2*	•	•	•	•	50-85	0,26	-	-	0,33	-	-	0,42	-	-	-	0,43	0,25
EV2/3-70-2*	•	•	•	•	60-115	0,36	-	-	0,47	-	-	0,56	-	-	-	0,43	0,25
EV 2/3-72-2	•	•	•	•	110-228	0,88	0,34	0,23	1,00	0,42	0,28	1,00	0,55	0,36	-	0,69	0,5
EV 3-100-2	•	•	•	•	123-294	1,27	0,64	0,4	1,31	0,77	0,48	1,36	1,0	0,56	1,41	1,51	0,74
EV 4-60-2	•	•	•	•	64-225	0,88	0,34	0,23	0,95	0,42	0,28	0,96	0,55	0,36	-	0,69	0,5
EV 4-75-2	•	•	•	•	95-307	1,27	0,64	0,4	1,31	0,77	0,48	1,36	1,0	0,56	1,41	1,51	0,74
EV 4-95-2	•	•	•	•	193-580	2,18	1,8	1,04	2,45	1,95	1,13	2,81	2,16	1,25	2,91	2,35	1,36
EV 5-88-2	•	•	•	•	233-632	2,18	1,8	1,04	2,45	1,95	1,13	2,81	2,16	1,25	2,91	2,35	1,36
EV 5-95-2	•	•	•	•	465-1037	4,2	2,65	1,4	4,67	2,9	1,56	5,0	3,3	1,75	5,3	3,74	1,95
EV 6-95-2	•	•	•	•	461-1030	4,2	2,65	1,4	4,67	2,9	1,56	5,0	3,3	1,75	5,3	3,74	1,95
EV 6-110-2	•	•	•	•	866-2153	-	5,32	2,9	-	6,0	3,2	-	6,55	3,5	11,3	6,9	3,8
EV 8-95-2	•	•	•	•	750-1187	3,8	2,85	1,5	4,6	3,2	1,72	5,8	3,5	2	6,2	4,1	2,2
EV 8-100-2	•	•	•	•	1220-2113	-	5,32	2,9	-	6,0	3,2	-	6,55	3,5	11,3	6,9	3,8
EV 8-120-2	•	•	•	•	1443-2870	-	7,0	3,85	-	7,8	4,21	-	8,5	4,65	-	9,61	5,15
EV 5-125-4	•	•	•	•	114-352	1,41	1,32	0,76	1,54	1,44	0,83	1,7	1,59	0,92	1,86	1,74	1,03
EV 6-125-4	•	•	•	•	184-524	1,93	1,28	1,05	2,16	1,51	1,16	2,37	1,78	1,29	2,6	2,25	1,4
EV 8-125-4	•	•	•	•	270-574	2,53	1,58	0,9	2,65	1,83	1,03	2,75	2,16	1,23	3,0	2,68	1,59

* No overload protection necessary. Other models have built-in thermal overload protection except EV 2/3-72-2 and EV 4-60-2. See Installation Guide for correct electrical protection. Pumps should always be installed with pump shaft horizontal. See Installation Guide

Whilst every care has been taken to ensure that data is correct, no responsibility can be accepted for inaccuracies or misprints.

It is SMEDEGAARD's policy to continually improve and develop the product range. We reserve the right to change specifications without prior notice.

SMEDEGAARD

OF DENMARK

T. Smedegaard A/S • Sydvestvej 57-59 • DK 2600 Glostrup • Denmark
 Tel +45 43 96 10 28 Fax +45 43 63 17 66
 E-mail: info@smedegaard.dk • www.smedegaard.com

RCB Motorenbau AG • Division Smedegaard Pumpen
 Industriestrasse 15 • CH-5712 Beinwil am See • Schweiz
 Tel +41 62 765 0500 • Fax +41 62 765 0501
 E-mail: smedegaard@rcbmotoren.ch • www.smedegaard.com

Smedegaard Pumps Unit 7 Barhams Close Wylds Road
 Bridgwater Somerset TA6 4 DS England
 Tel 01278 458686 Fax 01278 452454
 E-mail: smedegaardpumps@btinternet.com • www.smedegaard.com